

NOTES

1. All dimensions are in metres and all elevations are metres above Ordnance Datum unless noted otherwise. Do not scale from this drawing.
2. Reproduced from Ordnance Survey maps with the permission of Ordnance Survey on behalf of The Controller of Her Majesty's Stationery Office. Crown copyright. Licence number 0100031673.
3. Temporary working width shown for indicative purposes only, dimensions and design may vary depending on site and installation conditions.
4. Off site works to the highway to be applied for separately under Section 276 of Highways Act 1980.
5. For UK Onshore Scheme Site Location and Works Plans - Location Key Plan refer to VKL-02-34-G100-001.
6. LCC refers to Lincolnshire County Council
HGV refers to Heavy Goods Vehicles
AIL refers to Abnormal Indivisible Loads
7. Track / Access crossings to be Construction traffic crossing points only, unless noted otherwise.

LEGEND

- Application Boundary
- - - Local Planning Authority Administrative Boundary
- Indicative DC Cable Alignment
- - - Indicative AC Cable Alignment
- - - Temporary Construction Access Route
- - - Temporary Construction Access to Beach
- - - Limits of Deviation
- Temporary Working Width
- Temporary Construction Compound
- Temporary Working Area
- Temporary Working Area Ancillary Area
- Temporary Construction Compound Ancillary Area
- Converter Station Temporary Construction Facilities
- DX1/1 Drain Crossing Reference
- PRWX1/1 Public Right of Way Crossing Reference
- RDX1 Road Crossing Reference: Construction Traffic Crossing Only
- RDX1 Road Crossing Reference: Construction Access
- RLX34/1 Rail Crossing Reference
- RVX35/1 River Crossing Reference
- TX1/1 Track / Access Crossing Reference

KEY PLAN

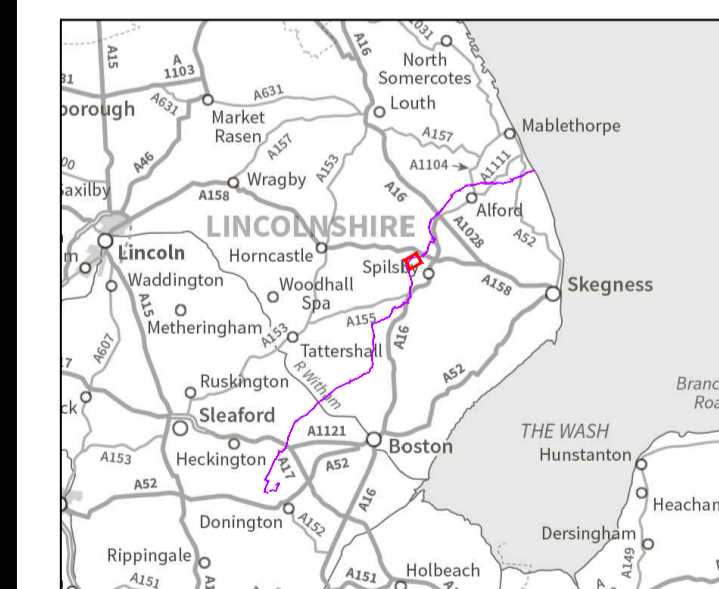

REVISION:

REV.	DATE	DESCRIPTION
00	02/08/17	For Planning

FIGURE NO.

VKL-02-34-G100-070

FIGURE TITLE

UK Onshore Scheme
Application Works Plans

SHEET NUMBER

Sheet 16

Scale at A1:

1:2500

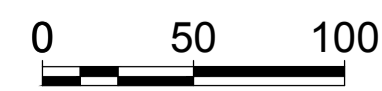
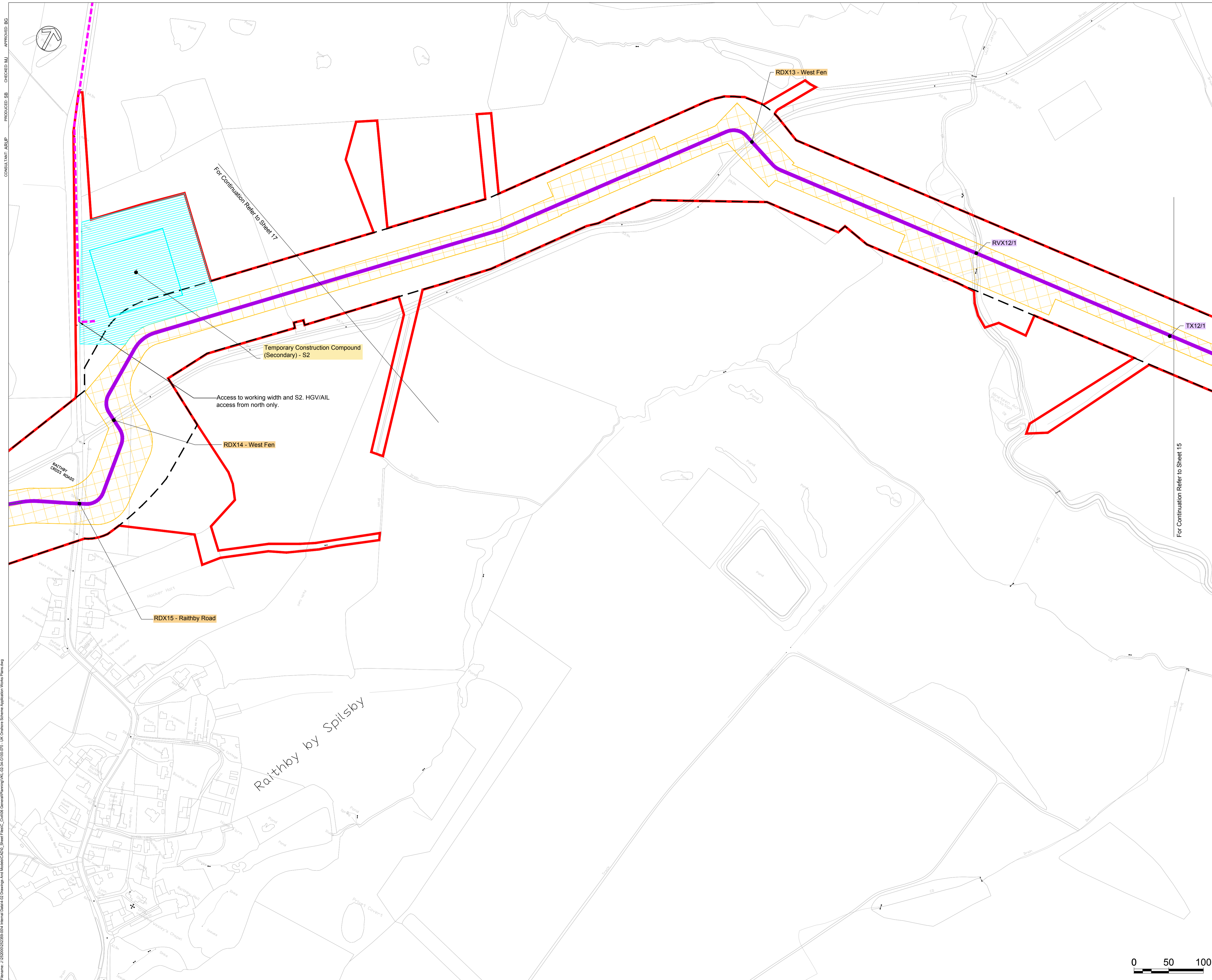

PRODUCED: SB CHECKED: MJ APPROVED: BG
 CONSULTANT: ARUP
 File name: I:\202005202004 Internal Data\A2 Drawings And Models\CAD_Sheet Files\C_Civil\06 Scheme Planning\VKL_02_34_G100_070_UK Onshore Scheme Application Works Plans.dwg
 © Crown Copyright and Database Rights 2017. Ordnance Survey 0100031673