

N

PLAN 22 OF 28 REFERRED TO IN THE NATIONAL GRID VIKING LINK LIMITED (VIKING LINK INTERCONNECTOR) COMPULSORY PURCHASE ORDER 2019 GENERAL VESTING DECLARATION NO.2

- Land Included in General Vesting Declaration
- Rights Included in General Vesting Declaration

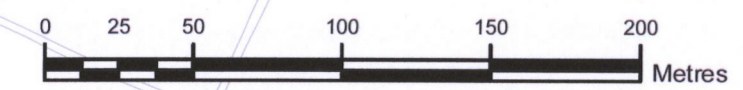
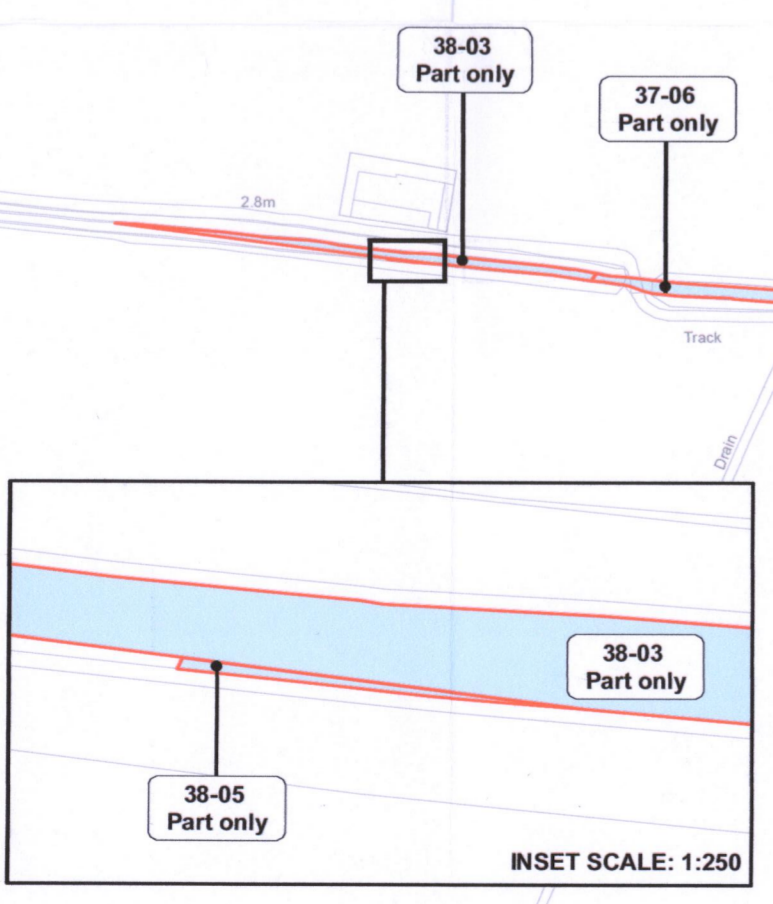
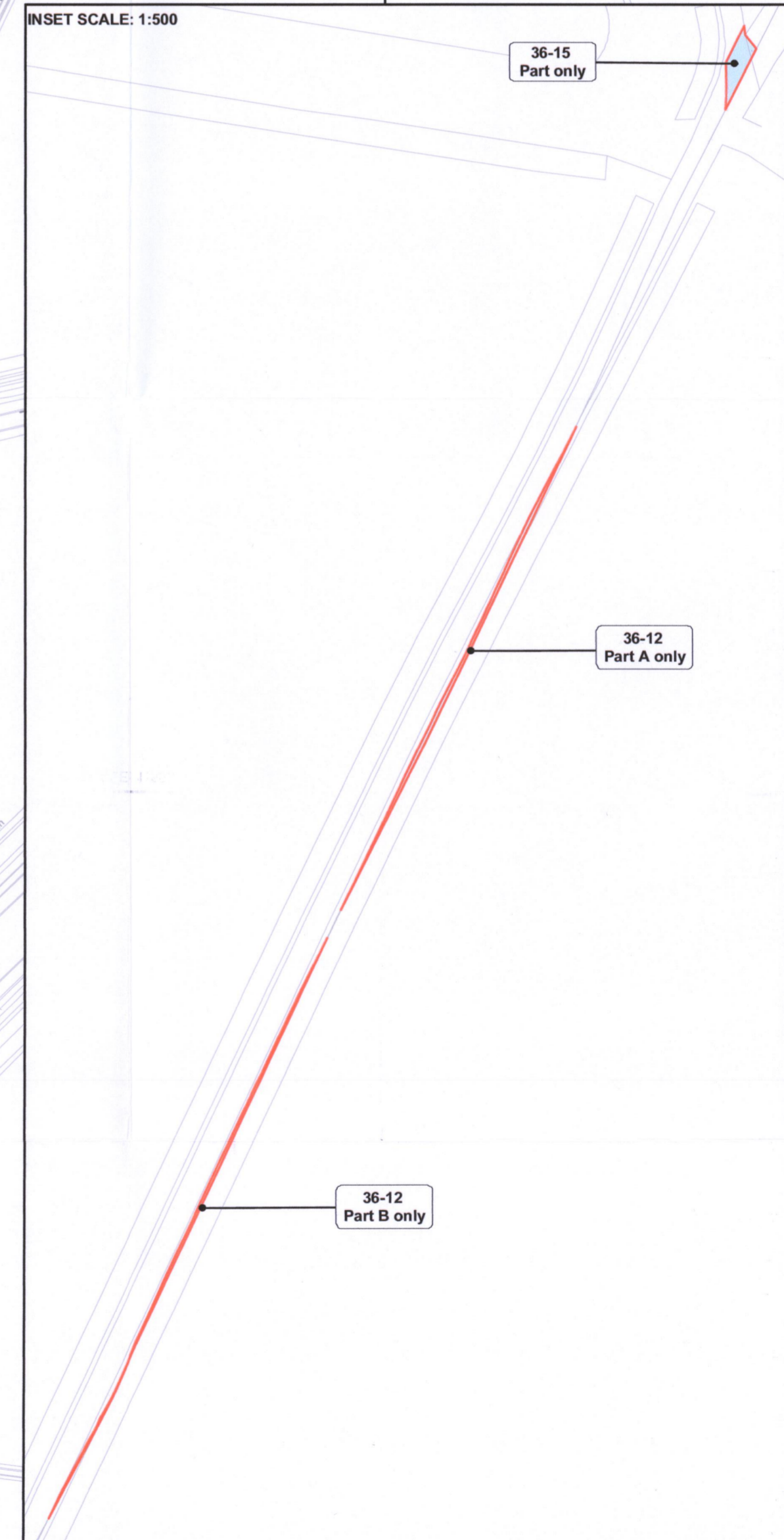
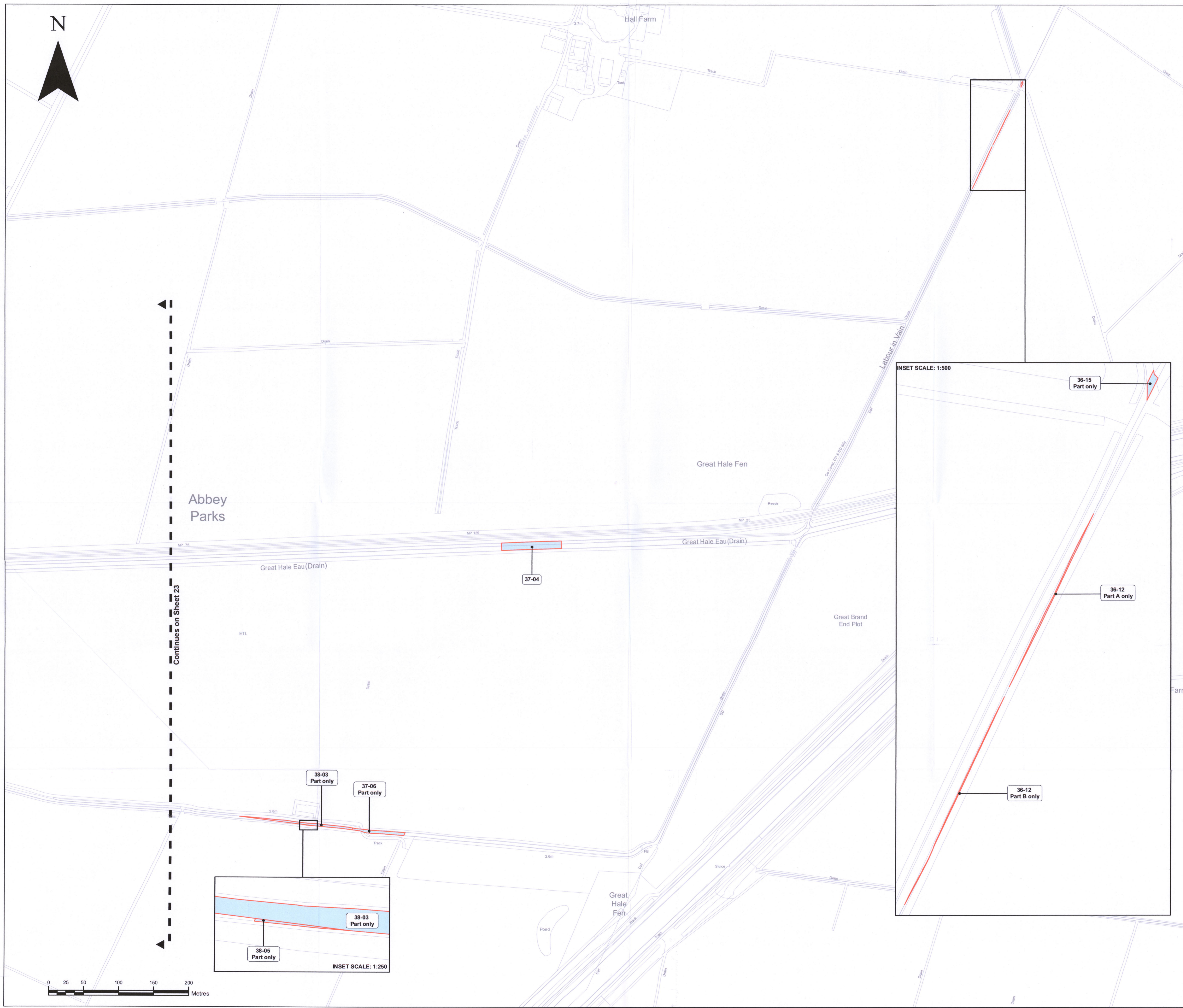

The common seal of NATIONAL GRID VIKING LINK LIMITED was hereunto affixed on the 20th October 2020 in the presence of :-
LAWRENCE HARRAN
Authorised Signatory

Crown copyright and database rights 2016 OS 100031673. You are permitted to use this data solely to enable you to respond to, or interact with, the organisation that provided you with the data. You are not permitted to copy, sub-licence, distribute or sell any of this data to third parties in any form.



DRAWING TITLE
Plan 22 of 28 referred to in the National Grid Viking Link Limited (Viking Link Interconnector) Compulsory Purchase Order 2019 General Vesting Declaration No.2

SITE		DRAWING NUMBER		PRINT A1	
DRAWING NUMBER		FORMAT GIS		SCALE	
REV	REMARKS	AUTHOR	CHKD	APPD	DATE
A	Draft	BS	NP	CM	20-10-2020
				SHT No.	No. of SHTS
				22	28
				SCALE 1:2500	

Co-financed by the European Union Connecting Europe Facility